



Oaklands House Oughtibridge Lane, Oughtibridge, Sheffield S35 8QD



Lettings

Oaklands House Oughtibridge

Oughtibridge

Per Month

£2,250 Per Month

This stunning villa on Oughtibridge Lane offers an exceptional blend of modern luxury and breathtaking rural vistas in the highly sought-after village of Oughtibridge. From the moment you step inside, the property commands attention with its high-quality internal and external finishes, designed flawlessly for both sophisticated entertaining and relaxed family living. The heart of the home is a spectacular, light-filled open-plan living, dining, and kitchen area. This culinary space features premium Calacatta Gold work surfaces, a generous central breakfast island, and a comprehensive suite of high-end integrated appliances, all complemented perfectly by a separate, practical utility room.

The bedroom accommodation is equally impressive, catering comfortably to growing families or visiting guests. The luxurious master suite boasts its own private en-suite, while three further well-proportioned double bedrooms share a contemporary three-piece family bathroom equipped with an over-bath shower.

Externally, the villa is enveloped by beautifully maintained wrap-around lawns and a spacious patio area, offering the perfect vantage point to take in the uninterrupted, panoramic countryside views. Enjoying the best of both worlds, the property sits on the doorstep of idyllic open countryside while remaining within easy reach of excellent local amenities. It also benefits from a highly desirable location within the catchment area for both Oughtibridge Primary School and Bradfield Secondary School.

This property is offered unfurnished. Please note that smoking is not permitted within the property. The Energy Efficiency Rating is C and Council Tax Band is E.

- New Build
- Spectacular Views
- Four Double Bedrooms
- Sought After Location
- High Specification
- Beautifully Designed And Fitted Out
- Garden With Views Over Adjoining Countryside
- Automatic Electric Gates





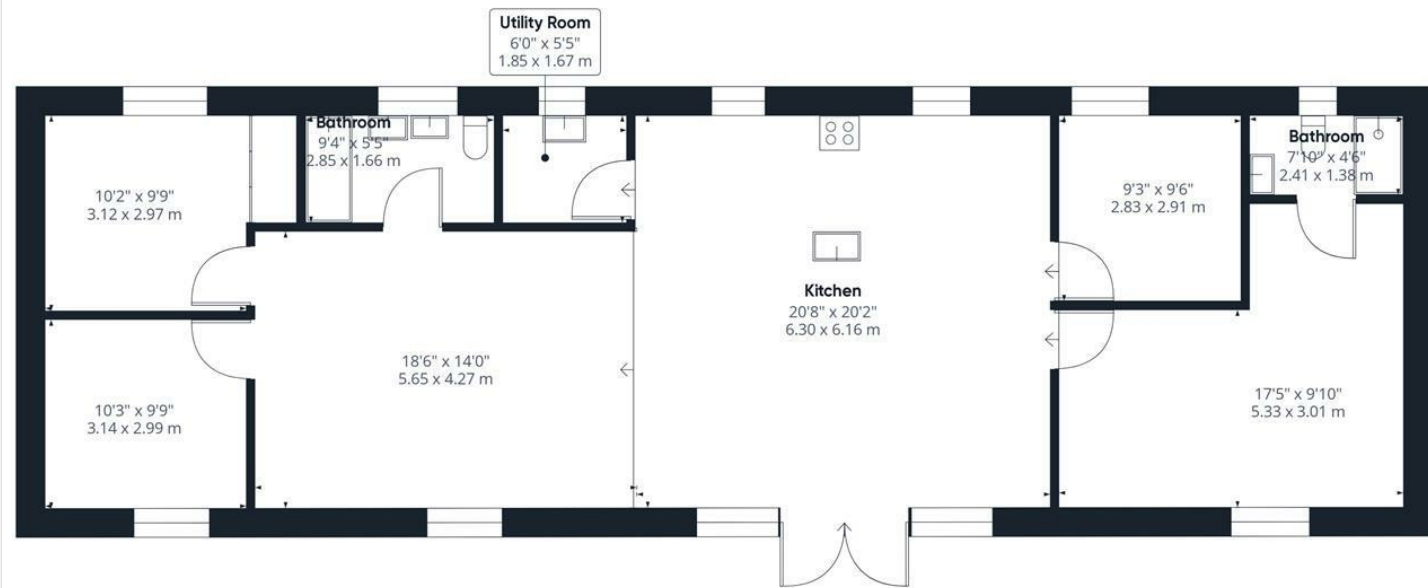

Approximate total area⁽¹⁾
1358.42 ft²
126.2 m²

(1) Excluding balconies and terraces.

While every attempt has been made to ensure accuracy, all measurements are approximate, not to scale. This floor plan is for illustrative purposes only.

GIRAFFE360

While we endeavour to make our sales particulars fair, accurate and reliable, they are only a general guide to the property and, accordingly, if there is any point, which is of particular importance to you, please contact the relevant office. The Agents have not tested any apparatus, equipment, fittings or services and so cannot verify they are in working order. The buyer is advised to obtain verification. Please note all the measurement details are approximate and should not be relied upon as exact. All plans, floor plans and maps are for guidance purposes only and are not to scale. Under no circumstances should they be relied upon as exact or for use in planning carpets and other such fixtures, fittings or furnishings. YOUR HOME IS AT RISK IF YOU DO NOT KEEP UP REPAYMENTS ON A MORTGAGE OR OTHER LOAN SECURED ON IT. 'A Life Assurance policy may be requested.' 'Written Quotations of credit terms available on request.'

Banner Cross
T: 0114 268 3241
E: bannercross@saxtonmee.co.uk
www.saxtonmee.co.uk

Hathersage
T: 01433 650009
E: hathersage@saxtonmee.co.uk

Bakewell
T: 01629 815307
E: bakewell@saxtonmee.co.uk

Matlock
T: 01629 828250
E: matlock@saxtonmee.co.uk